

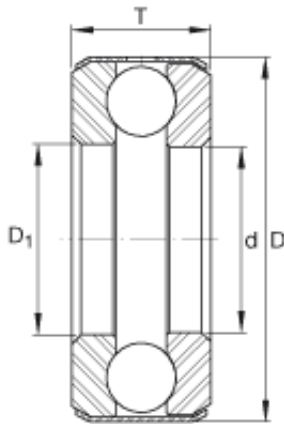

BM Bearing Power Machinery Co., Ltd.



B39 Bearing 2D drawings and 3D CAD models

GATES B39 high quality B type wrapped v belt for brazil market

Bearing No. B39

Size	74.613x116.69x28.58 mm
Bore Diameter	74,613 mm
Outer Diameter	116,69 mm
Width	28,58 mm
d	2 15/16 inch
d	74,613 mm
D	4,594 inch
D	116,69 mm
T	1,125 inch
T	28,58 mm
D ₁	2,969 inch
m	2,428 lbs / Weight
m	1,101 kg / Weight
C _a	21400 lbf / Dynamic load rating (axial)
C _a	95000 N / Dynamic load rating (axial)
C _{0a}	57000 lbf / Static load rating (axial)
C _{0a}	254000 N / Static load rating (axial)
Category	Thrust Ball Bearing
Inventory	0.0
Manufacturer Name	SCHAEFFLER GROUP
Minimum Buy Quantity	N/A
Weight / Kilogram	1.318
Product Group	B00308



BM Bearing Power Machinery Co., Ltd.

Rolling Element	Ball Bearing
Thrust Bearing	Yes
Single or Double Direction	Single Direction
Banded	Yes
Cage Material	Steel
Precision Class	ABEC 1 ISO P0
Component Description	Roller Assembly Plus Raceways
Other Features	Single Row With Flat Seat
Long Description	2-15/16" Bore 1; 2-31/32" Bore 2; 4-19/32" Outside Diameter; 1-1/8" Height; Ball Bearing; Single Direction; Banded; Steel Cage; ABEC 1 ISO P0 Precision
Inch - Metric	Inch
Category	Thrust Ball Bearings
UNSPSC	31171552
Harmonized Tariff Code	8482.10.50.08
Noun	Bearing
Keyword String	Ball Thrust
Manufacturer URL	http://www.ina.com
Bore 1	2.938 Inch 74.625 Millimeter
Bore 2	2.969 Inch 75.413 Millimeter
Overall Height with Aligning Washer	0 Inch 0 Millimeter
Height	1.125 Inch 28.575 Millimeter
Outside Diameter	4.594 Inch 116.688 Millimeter